

Bally

REFRIGERATORS

Designer-line

FREEZERS

Utilizing Environmentally Safe, CFC-free R-404A Refrigerant



GRIDDLE STAND FREEZERS

Standard Features

- Stainless Steel Exterior and Interior
- Plasticized Fin Evaporator Coil
- Capillary Dial Thermometer
- Anti-Sweat Drawer Heaters
- Chrome-Plated Hardware
- Heavy-Duty Diecast Flow-line Handle
- Heavy Gauge, Reinforced Stainless Steel Finished Work Top With Drip Guard, Marine Edge
- One Piece Magnetic Snap-In Drawer Gaskets
- Automatic, Energy Saving, Non-Electric Condensate Disposal
- Non-CFC Polyurethane Foam Insulation
- Easy Glide, Self-Closing Heavy-Duty Drawers
- Adjustable 6" Stainless Steel Legs
- 10' Cord and Plug Attached
- Performance Tested Refrigeration System Utilizing Environmentally Safe R-404A Refrigerant
- Automatic Electric Defrost

Optional Features & Accessories

- Heavy-Duty Casters
- Remote Models
- Stainless Steel Pans
- Special Electrical Requirements
- Digital Thermometer

Refrigeration System

The self-contained refrigeration system is mounted within a side mounted housing, concealed behind a stainless steel louvered grille. Full length air grille allows for even air circulation to condensing unit. A "Performance Rated", air-cooled, hermetically sealed, capillary type refrigeration system is installed in each model. Contained behind mullion are a plasticized finned coil and air circulating fans. Our unique air flow design allows the cabinet to be enclosed on both sides or, to be mounted flush against a wall. Our refrigeration system, fully charged with R-404A refrigerant, is designed to maintain 0°F while operating with an unrestricted air supply in ambient temperature of 100° Fahrenheit. All condensate water is directed to a non-electric condensate vaporizer located in the compressor compartment, thus, no plumbing is required. A strict quality assurance team inspects all materials and components to certify that each model conforms to the most exacting standards. All models are performance tested for a minimum of 16 hours prior to crating.

Cabinet Construction

All materials are of top quality, and are assembled under rigid supervision conforming to strict quality assurance requirements. Case is of all metal welded construction and is internally supported and braced for rigid unit construction. Exterior cabinet back and bottom are of heavy gauge galvanized steel. Work top is constructed of heavy gauge polished stainless steel for durability.

Cabinet design eliminates overlapping panels with raw edges. Interior corners are rounded with a 1/4" radius for cleaning ease. All cabinet joints and seams are vapor-tight sealed. Easily removable anti-sweat drawer heaters, concealed by a non-metallic, non-conductive, high impact thermal breaker strip, eliminates condensation build-up on case front.

Insulation

All cabinet walls, top, and bottom have high density, Foamed-in-place, non-CFC polyurethane insulation.

Drawer Construction

Drawer fronts and backs are constructed of heavy gauge, polished stainless steel with heavy duty, safety grip, chrome plated handles. All drawer fronts are insulated with non-CFC polyurethane foam insulation. Full extension, lift-out type drawer frames are of heavy gauge, welded stainless steel mounted on heavy duty, easy glide, self closing drawer slides. Each drawer holds two 12" x 20" x 4" deep pans (not furnished). Self adjusting, full perimeter, magnetic snap-in gaskets guarantee a positive seal.





SPECIFICATIONS

| | DL1GF-SS One Section | | DL2GF-SS Two Section | |
|---------------------------------------|--------------------------------|--------------------------------|--------------------------------|--------------------------------|
| | Self-Contained | Remote | Self-Contained | Remote |
| DIMENSIONAL DATA | | | | |
| Net Capacity (cu. ft.) | 6.0 | 6.0 | 12.0 | 12.0 |
| Width, Overall (in.) | 50 ³ / ₄ | 37 ⁵ / ₈ | 76 ³ / ₈ | 63 ¹ / ₄ |
| Depth, Overall (incl. Hdls.) (in.) | 35 | 35 | 35 | 35 |
| Depth, Body Only (Less Door(s))(in.) | 33 ⁵ / ₈ | 33 ⁵ / ₈ | 33 ⁵ / ₈ | 33 ⁵ / ₈ |
| Height, Overall (incl. 6" Legs) (in.) | 26 | 26 | 26 | 26 |
| Drawers (Std.) | 2 | 2 | 4 | 4 |
| 12"x20" Pans (Not Furnished) | 4 | 4 | 8 | 8 |

REFRIGERATION DATA

| | | | | |
|-----------------------------|------|------|------|------|
| Condensing Unit Size (H.P.) | 1/4 | - | 1/3 | - |
| Capacity (BTU/HR)* | 1250 | 1250 | 1590 | 1590 |

ELECTRICAL DATA

| | | | | |
|--------------------------|----------|----------|----------|----------|
| Cabinet Specifications | 115/60/1 | 115/60/1 | 115/60/1 | 115/60/1 |
| Condensing Unit Specs. | 115/60/1 | - | 115/60/1 | - |
| Cabinet Amperes | 1.6 | 1.6 | 1.6 | 1.6 |
| Total Amperes | 6.0 | 1.6 | 7.6 | 1.6 |
| Power Supply Cord 10 Ft. | Yes | Yes | Yes | Yes |

SHIPPING DATA

| | | | | |
|------------------------|-----|-----|-----|-----|
| Height-crated (in.) | 44 | 44 | 44 | 44 |
| Width-crated (in.) | 65 | 65 | 109 | 109 |
| Depth-crated (in.) | 41 | 41 | 41 | 41 |
| Volume-crated (cu.ft.) | 61 | 61 | 103 | 103 |
| Weigh-crated (lbs.) | 450 | 390 | 580 | 520 |

* Rating @ -15°F Evaporator, 90° Ambient

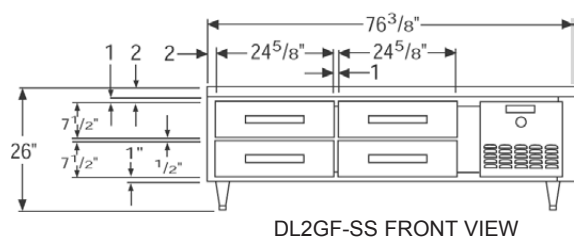
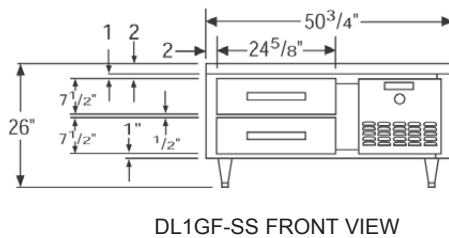
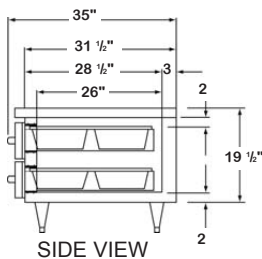

A Division of BALMAC International, Inc.
 61 Broadway, Suite 1900, New York, NY 10006-2701
 (212) 898-9699 Fax: (212) 514-9234
www.bmil.com - bmil@bmil.com